

1. MECHANICAL DIMENSIONS :

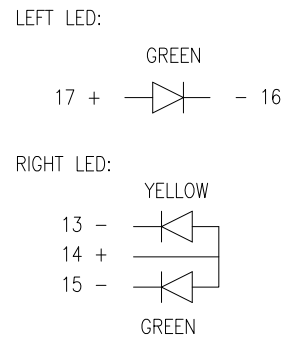

2. PCB LAYOUT :

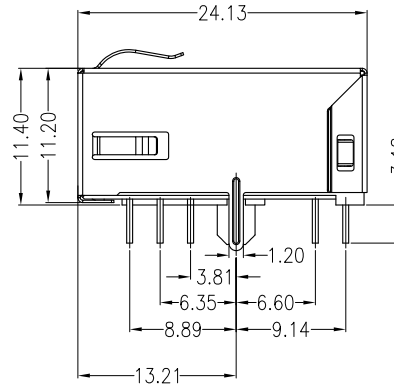
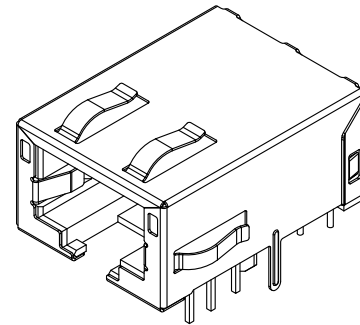
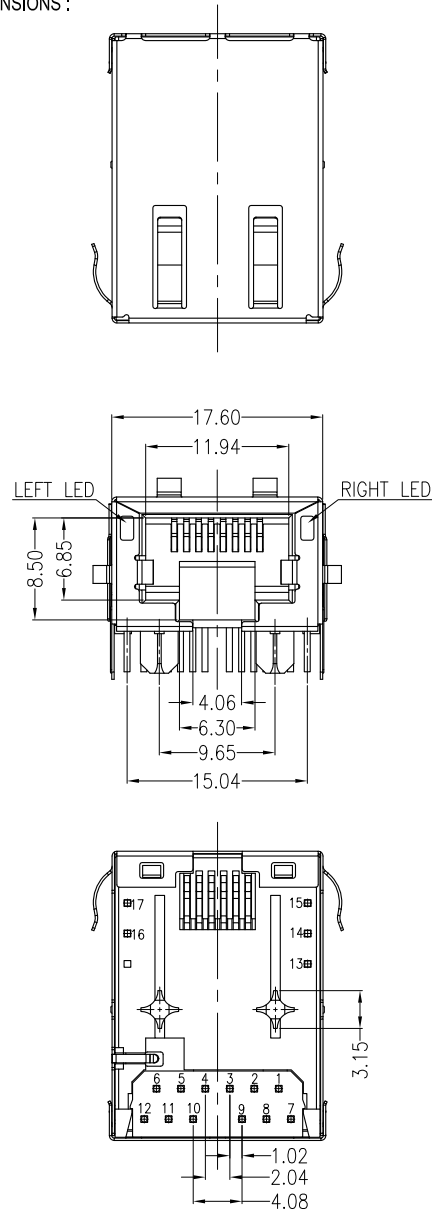
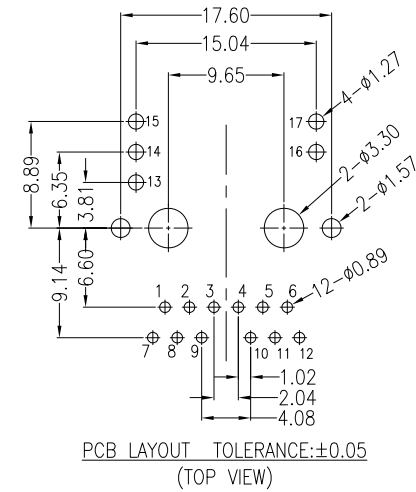

NOTES:

- MATERIAL:
HOUSING:LCP,BLACK,UL 94V-0
CONTACT:PHOSPHOR BRONZE,T=0.30mm.
SHELL:BRASS,T=0.20mm.
- FINISH:
CONTACT:50u"MIN. NICKEL UNDERPLATING ALL AREA,
100u"MIN. TIN ON SOLDER TAILS,
15u"MIN GOLD PLATING ON CONTACT AREA .
SHELL:30u"MIN. NICKEL PRE-PLATING ALL AREA.
- OPERATING TEMPERATURE:0°C~+70°C.
- JACK CAVITY CONFORMS TO FCC RULES AND REGULATIONS PART 68, SUBPART F

REV.	ECN. NO.	DRAWN	DATE	EC.content
A.0	NEW	Tony	07/04/2017	



⊗: QUALITY CONTROL ITEM		GENERAL TOLERANCE	PART NO.: FDD-CA4D-58C9		
APPROVED		.X± 0.38 X.'± 2'	TITLE:RJ45 CONN W/ LED, 8P12C HOLE 10000MBPS, FILTER		
CHECKED		.XX± 0.25 .X'± 1'			
DRAWN		.XXX± 0.13	UNIT: mm	SCALE: 1:1	SHEET: 1/2
					REV.: A.0

說明: △:備註 ◇:版本變更 ①:尺寸序號 ■:重點尺寸 ▼:CPK尺寸

DOCUMENT NO. : ZER0013/A.3

SIZE: A4

3. SCHEMATIC:

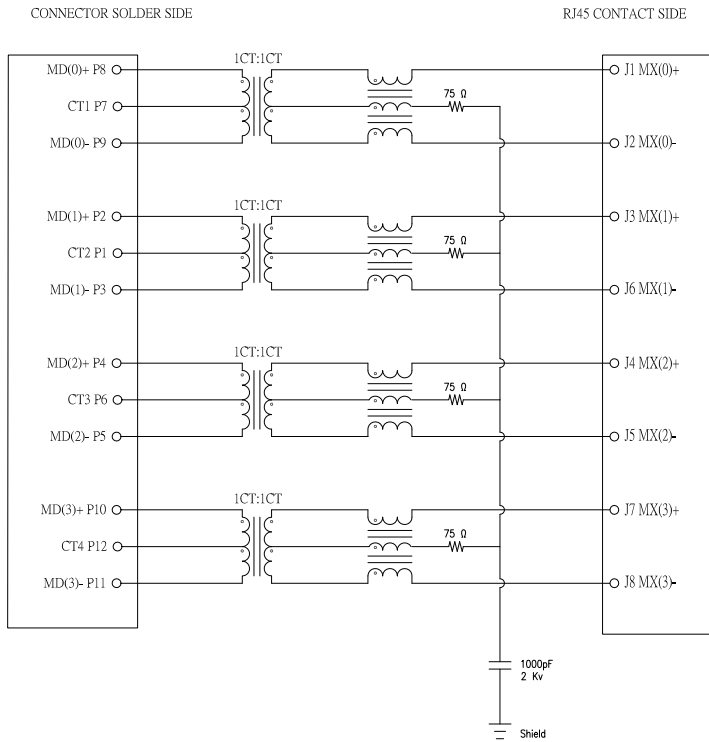

E-CONN PART NO:

F D D - C A 4 D - 5 8 C 9

SHELL CODE
ALL SPRING

HOUSING CODE
LCP, BLACK

LED COLOR OPTION
LEFT LED: GREEN
RIGHT LED: GR/YE

CIRCUIT TYPE

PLATING CODE
GOLD 15u"

4. ELECTRICAL CHARACTERISTICS :

TEST NOTES:(0°~70°C)

1. TR:(100KHz,0.1V); 100%

PINS:(P8,P9):(J1,J2)=1:1±3%:(P2,P3):(J3,J6)=1:1±3%

PINS:(P4,P5):(J4,J5)=1:1±3%:(P10,P11):(J7,J8)=1:1±3%

2. LX:(100KHz,100mV,8mA, DC Bias) 100%

PINS:(P8,P9),(P2,P3)=160uH MINIMUM

PINS:(P4,P5),(P10,P11)=160uH MINIMUM

3. DCR: 100%

PINS:(J1,J2),(J3,J6)=1.2Ω MAXIMUM

PINS:(J4,J5),(J7,J8)=1.2Ω MAXIMUM

4. HIPOT: 100%

PINS(P8,P9)TO(J1,J2),(P2,P3)TO(J3,J6)=1500VAC FOR 60 SECONDS

PINS(P4,P5)TO(J1,J2),(P10,P11)TO(J3,J6)=1500VAC FOR 60 SECONDS

5. INSERTION LOSS:

-0.7dB MAXIMUM AT 1MHz TO 200MHz;

-1.4dB MAXIMUM AT 200MHz TO 400MHz;

6. RETURN LOSS:

-22dB MINIMUM AT 1MHz TO 100MHz;

-22+18.27*log(Freq MHz/100MHz) dB MINIMUM AT 100MHz TO 500MHz

7. CROSS TALK:

-28dB MINIMUM AT 1MHz TO 100MHz

-19dB MINIMUM AT 100MHz TO 500MHz

8. COMMON TO COMMON MODE REJECTION:

-30dB MINIMUM AT 1MHz TO 40MHz

-28dB MINIMUM AT 40MHz TO 100MHz

-26dB MINIMUM AT 100MHz TO 500MHz

9. CM TO DM CONVERSION:

-30dB MINIMUM AT 1MHz TO 250MHz

-22dB MINIMUM AT 250MHz TO 500MHz

REV.	ECN. NO.	DRAWN	DATE	EC.content
A.0	NEW	Tony	07/04/2017	



⊗: QUALITY CONTROL ITEM		GENERAL TOLERANCE .X± 0.38 X.'± 2' .XX± 0.25 .X'± 1' .XXX± 0.13		PART NO.: FDD-CA4D-58C9		
APPROVED				TITLE:RJ45 CONN W/ LED, 8P12C		
CHECKED				HOLE 10000MBPS, FILTER		
DRAWN		UNIT: mm		SCALE: 1:1	SHEET: 2/2	REV.: A.0