

1. MECHANICAL DIMENSIONS :

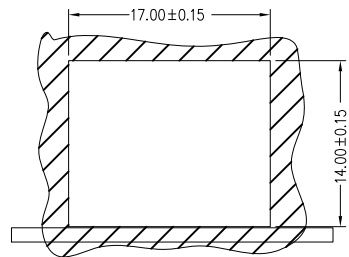

RECOMMENDED PANEL OPENING

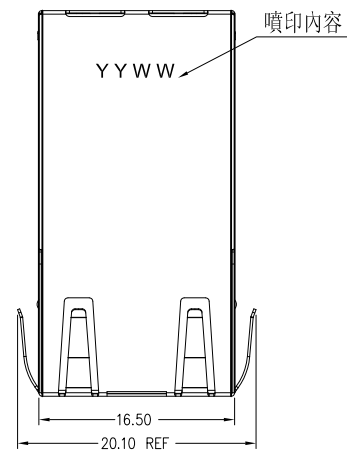
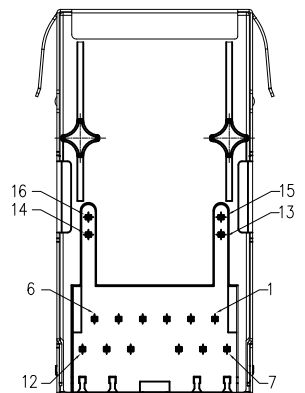
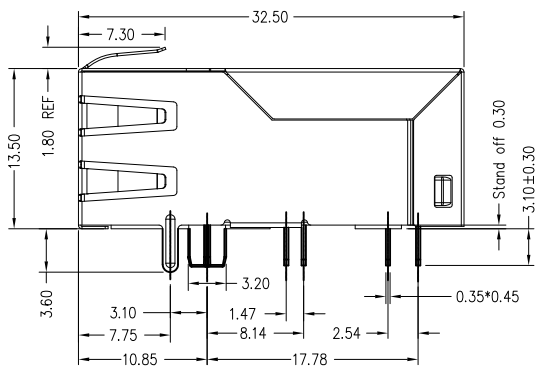
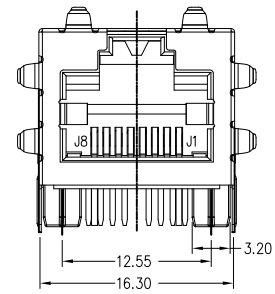

2. PCB LAYOUT :

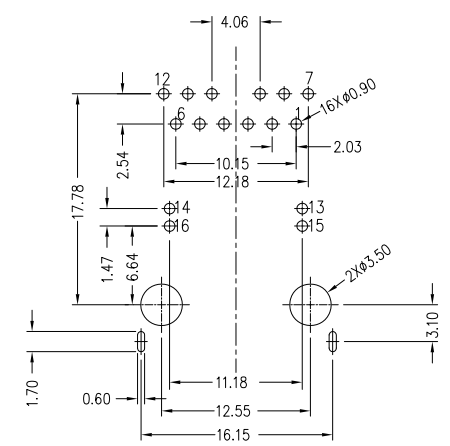

SUGGESTED PCB LAYOUT
DIMENSIONAL TOLERANCE: .XX ± 0.05[0.002]

NOTES:

- MATERIAL:
HOUSING: HIGH TEMP.THERMOPLASTIC,BLACK,UL 94V-0
CONTACT: PHOSPHOR BRONZE,T=0.30mm.
SHELL: BRASS,T=0.20mm.
- FINISH:
CONTACT: 50u"MIN. NICKEL UNDERPLATING ALL AREA,
100u"MIN. TIN ON SOLDER TAILS,
PLATING 30u' MIN GOLD ON CONTACT AREA
SHELL: 30u"MIN. NICKEL PRE-PLATING ALL AREA
- OPERATING TEMPERATURE: 0C~+70°C.
- JACK CAVITY CONFORMS TO FCC RULES AND REGULATIONS PART 68, SUBPART F

REV.	ECN. NO.	DRAWN	DATE	EC.content
A	NEW	Tony	06/28/2017	



⊗: QUALITY CONTROL ITEM	GENERAL TOLERANCE .X ± 0.38 X: ± 2' .XX ± 0.25 .X: ± 1' .XXX ± 0.13	PART NO.: FTC-CA10-68P8		
APPROVED		TITLE: RJ45, CONNECTORS, W/LED		
CHECKED		10G+POE FILTER		
DRAWN	UNIT: mm	SCALE: 1:1	SHEET: 1/2	REV.: A

3. SCHEMATIC:

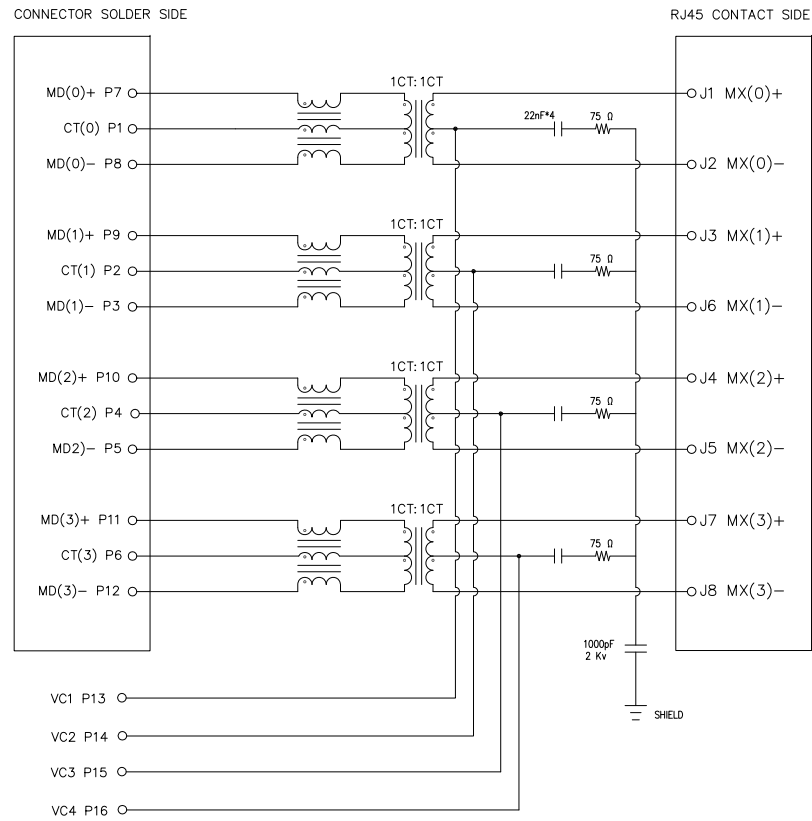

E-CONN PART NO:

FTC - CA 10 - 6 8 P 8

SHELL CODE _____
 HOUSING CODE _____
 LED COLOR OPTION _____
 _____ CIRCUIT TYPE
 _____ PLATING CODE

4. ELECTRICAL CHARACTERISTICS :

TEST NOTES: (25±5°C)

- TR: (100KHz, 0.1V); 100%
 PINS: (P7,P8): (J1, J2)=1: 1±3%; (P9,P3): (J3, J6)=1: 1±3%
 PINS: (P10,P5): (J4, J5)=1: 1±3%; (P11,P12): (J7, J8)=1: 1±3%
- LX: (100KHz, 100mV, 8mA, DC Bias) 100%
 PINS: (P7,P8), (P9,P3), (P10,P5), (P11,P12)=160uH MINIMUM
- DCR: 100%
 PINS: (J1, J2), (J3, J6), (J4, J5), (J7, J8)=1.2 Ω MAXIMUM
- HIPOT: 100%
 PINS (P7,P8) TO (J1, J2), (P9,P3) TO (J3, J6)=1500VAC FOR 2 SECONDS
 PINS (P10,P5) TO (J4, J5), (P11, P12) TO (J7, J8)=1500VAC FOR 2 SECONDS
- INSERTION LOSS:
 -1.0dB MAXIMUM AT 1MHz TO 200MHz;
 -2.0dB MAXIMUM AT 200MHz TO 400MHz;
 -3.0dB MAXIMUM AT 400MHz TO 500MHz;
- RETURN LOSS:
 -20dB MINIMUM AT 1MHz TO 40MHz;
 -20+15*LOG(FREQ MHZ/40MHZ) dB MINIMUM AT 40MHz TO 200MHz
- CROSS TALK:
 -30dB MINIMUM AT 1MHz TO 100MHz
 -25dB MINIMUM AT 100MHz TO 200MHz
 -20dB MINIMUM AT 200MHz TO 500MHz
- COMMON TO COMMON MODE REJECTION:
 -25dB MINIMUM AT 1MHz TO 100MHz
 -20dB MINIMUM AT 100MHz TO 500MHz
- CM TO DM REJECTION:
 -30dB MINIMUM AT 1MHz TO 500MHz
- Balanced DC LINE CURRENT
 600mA MAX@48V DC CONNTINUOUS

REV.	ECN. NO.	DRAWN	DATE	EC.content
A	NEW	Tony	06/28/2017	



⊗: QUALITY CONTROL ITEM		GENERAL TOLERANCE .X±0.38 X.'±2' .XX±0.25 .X'±1' .XXX±0.13		PART NO.: FTC-CA10-68P8		
APPROVED				TITLE:RJ45,CONNECTORS,W/LED		
CHECKED				10G+POE FILTER		
DRAWN		UNIT: mm		SCALE:1:1	SHEET: 2/2	REV.: A

説明: △:備註 ◇:版本變更 ①:尺寸序號 ■:重點尺寸 ▼:CPK尺寸

DOCUMENT NO. : ZER0013/A.3

SIZE: A4